

Zeitschrift: Eclogae Geologicae Helvetiae
Herausgeber: Schweizerische Geologische Gesellschaft
Band: 82 (1989)
Heft: 3

Artikel: Lower Anisian ammonoids from the northern Humboldt Range (northwestern Nevada, USA) and their bearing upon the Lower-Middle Triassic boundary
Autor: Bucher, Hugo
Anhang: Plates
Autor: [s.n.]
DOI: <https://doi.org/10.5169/seals-166409>

Nutzungsbedingungen

Die ETH-Bibliothek ist die Anbieterin der digitalisierten Zeitschriften auf E-Periodica. Sie besitzt keine Urheberrechte an den Zeitschriften und ist nicht verantwortlich für deren Inhalte. Die Rechte liegen in der Regel bei den Herausgebern beziehungsweise den externen Rechteinhabern. Das Veröffentlichen von Bildern in Print- und Online-Publikationen sowie auf Social Media-Kanälen oder Webseiten ist nur mit vorheriger Genehmigung der Rechteinhaber erlaubt. [Mehr erfahren](#)

Conditions d'utilisation

L'ETH Library est le fournisseur des revues numérisées. Elle ne détient aucun droit d'auteur sur les revues et n'est pas responsable de leur contenu. En règle générale, les droits sont détenus par les éditeurs ou les détenteurs de droits externes. La reproduction d'images dans des publications imprimées ou en ligne ainsi que sur des canaux de médias sociaux ou des sites web n'est autorisée qu'avec l'accord préalable des détenteurs des droits. [En savoir plus](#)

Terms of use

The ETH Library is the provider of the digitised journals. It does not own any copyrights to the journals and is not responsible for their content. The rights usually lie with the publishers or the external rights holders. Publishing images in print and online publications, as well as on social media channels or websites, is only permitted with the prior consent of the rights holders. [Find out more](#)

Download PDF: 13.12.2025

ETH-Bibliothek Zürich, E-Periodica, <https://www.e-periodica.ch>

Plate 1

All figures natural size

- Fig. 1. *Metadagnoceras* sp. indet. (p. 963). *Japonites welteri* beds. Loc. HB 184, Star Creek Canyon, northern Humboldt Range. USNM 438308.
- Fig. 2–5. *Metadagnoceras youngi* n. sp. (p. 963). *Mulleri* Zone. Loc. HB 56, Coyote Canyon, northern Humboldt Range.
2: paratype, USNM, 438309.
3: holotype, USNM 438310.
4: paratype, USNM 438311.
5: paratype, USNM 438312.
- Fig. 6–7. *Paracrochordiceras silberlingi* n. sp. (p. 971). *Pseudokeyserlingites guexi* beds. Loc. HB 223, Coyote Canyon, northern Humboldt Range.
6: paratype, USNM 438313.
7: holotype, USNM 438314.
- Fig. 8–10. *Paracrochordiceras* sp. indet. (p. 971). *Japonites welteri* beds. Northern Humboldt Range.
8: USNM 438315, loc. HB 235, Coyote Canyon.
9: USNM 438316, float from the lowermost strata of the Fossil Hill Member, Congress Canyon.
10: USNM 438317, loc. HB 235, Coyote Canyon.
- Fig. 11. *Japonites welteri* n. sp. (p. 978). *Japonites welteri* beds. Loc. HB 184, Star Creek Canyon, northern Humboldt Range. Plesiotype, USNM 438318.

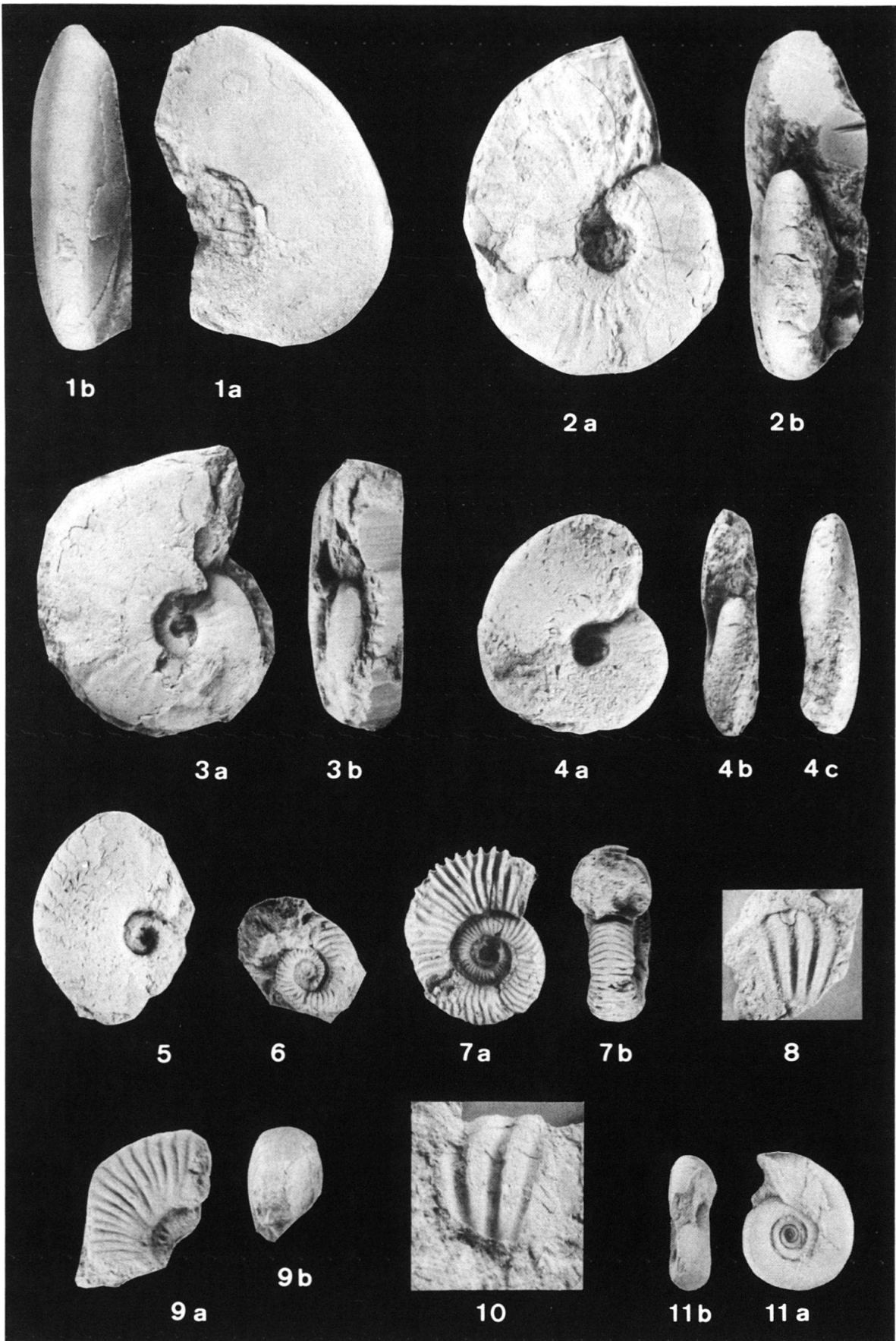

Plate 2

All figures natural size

- Fig. 1. *Japonites* cf. *J. surgriva* DIENER (p. 979). *Caurus* Zone. Loc. HB 180, Bloody Canyon northern Humboldt Range. Plesiotype, USNM 438319.
- Fig. 2–5. *Pseudokeyserlingites guexi* n. gen. n. sp. (p. 966). *Pseudokeyserlingites guexi* beds. Northern Humboldt Range.
2: plesiotype, USNM 438320, loc. HB 250, John Brown Canyon.
3: plesiotype, USNM 438321, loc. HB 251, Bloody Canyon. a, b and c respectively lateral, ventral and dorsal views.
4: paratype, USNM 438322, loc. HB 138, Coyote Canyon.
5: holotype, USNM 438323, loc. HB 138, Coyote Canyon.
- Fig. 6. *Stenopopanoceras* sp. indet. (p. 965). Lower Anisian. Loc. HB 96, Coyote Canyon, northern Humboldt Range. USNM 438324.
- Fig. 7. *Japonites starensis* n. sp. (p. 980). *Japonites welteri* beds. Loc. HB 184, Star Creek Canyon, northern Humboldt Range. Holotype, USNM 438325.

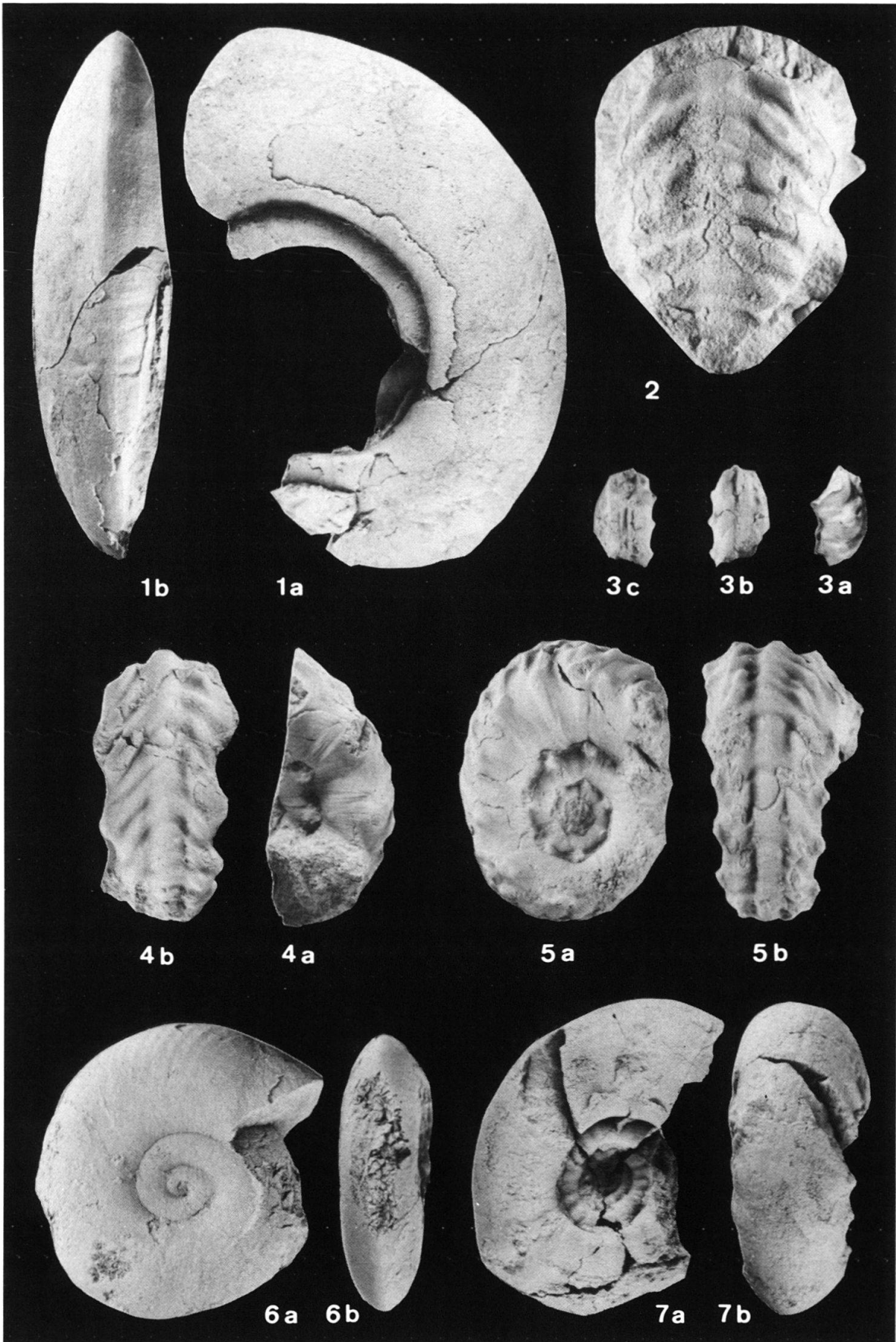

Plate 3

All figures natural size

Fig. 1–11. *Silberlingites mulleri* n. gen. n. sp. (p. 968). *Mulleri* Zone. Loc. HB 56, Coyote Canyon, northern Humboldt Range.

- 1: paratype, USNM 438326.
- 2: holotype, USNM 438327.
- 3: paratype, USNM 438328.
- 4: paratype, USNM 438329.
- 5: paratype, USNM 438330.
- 6: paratype, USNM 438331.
- 7: paratype, USNM 438332.
- 8: paratype, USNM 438333.
- 9: paratype, USNM 438334.
- 10: paratype, USNM 438335.
- 11: paratype, USNM 438336.

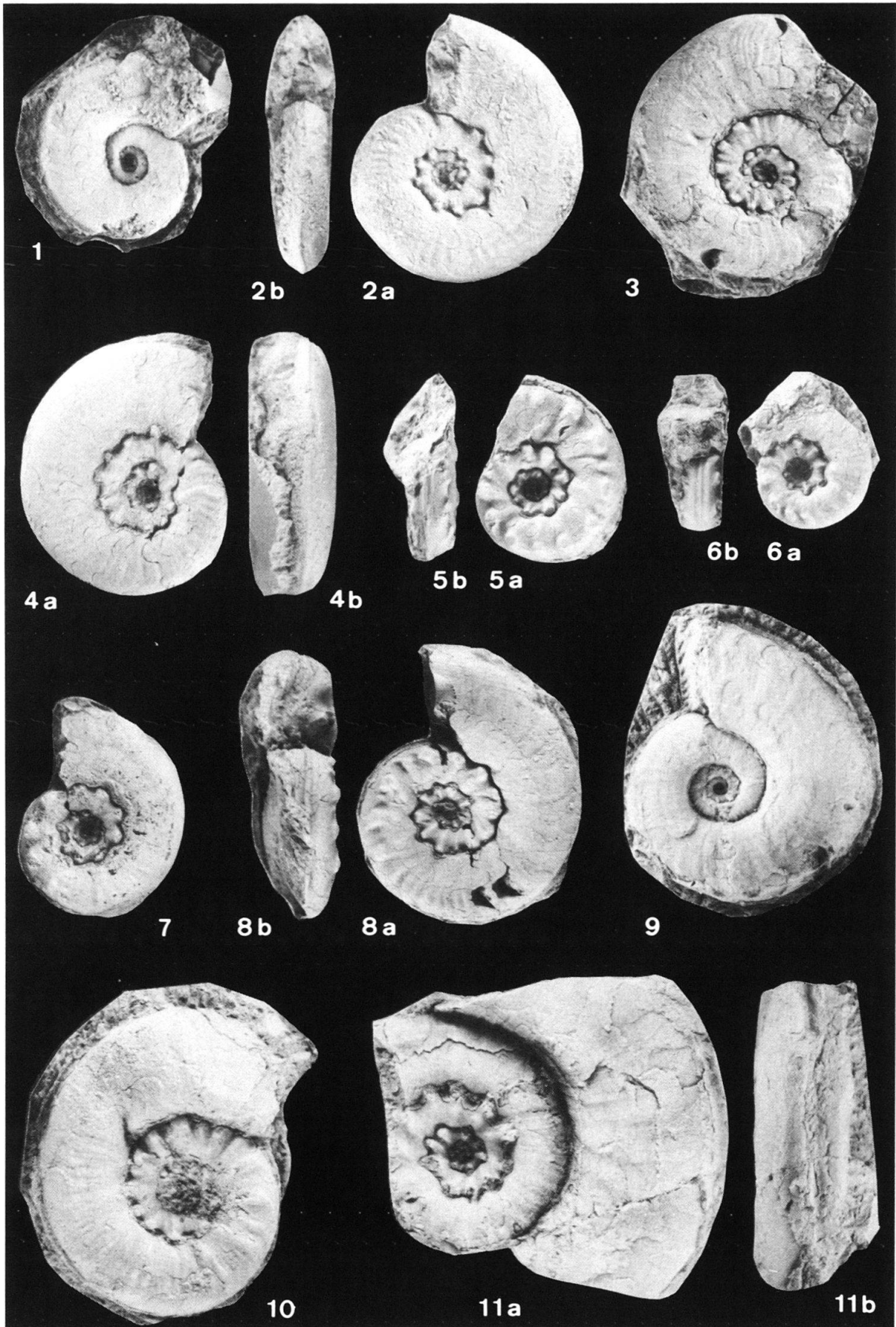

Plate 4

All figures natural size

- Fig. 1–4. *Silberlingites mulleri* n. gen. n. sp. (p. 968). *Mulleri* Zone. Loc. HB 56, Coyote Canyon, northern Humboldt Range.
1: paratype, USNM 438337.
2: paratype, USNM 438338.
3: paratype, USNM 438339.
4: paratype, USNM 438340.
- Fig. 5–12. *Silberlingites tregoi* n. gen. n. sp. (p. 970). *Mulleri* Zone. Coyote Canyon, northern Humboldt Range.
5: paratype, USNM 438341, loc. HB 56.
6: paratype, USNM 438342, loc. HB 56.
7: paratype, USNM 438343, loc. HB 56.
8: holotype, USNM 438344, loc. HB 56.
9: plesiotype, USNM 438345, loc. HB 115.
10: paratype, USNM 438346, loc. HB 56.
11: plesiotype, USNM 438347, loc. HB 115.
12: paratype, USNM 438348, loc. HB 56.
- Fig. 13–14. *Sageceras* cf. *S. walteri* Mojsisovics (p. 962). *Mulleri* Zone. Loc. HB 56, Coyote Canyon, northern Humboldt Range.
13: plesiotype, USNM 438349.
14: plesiotype, USNM 438350.

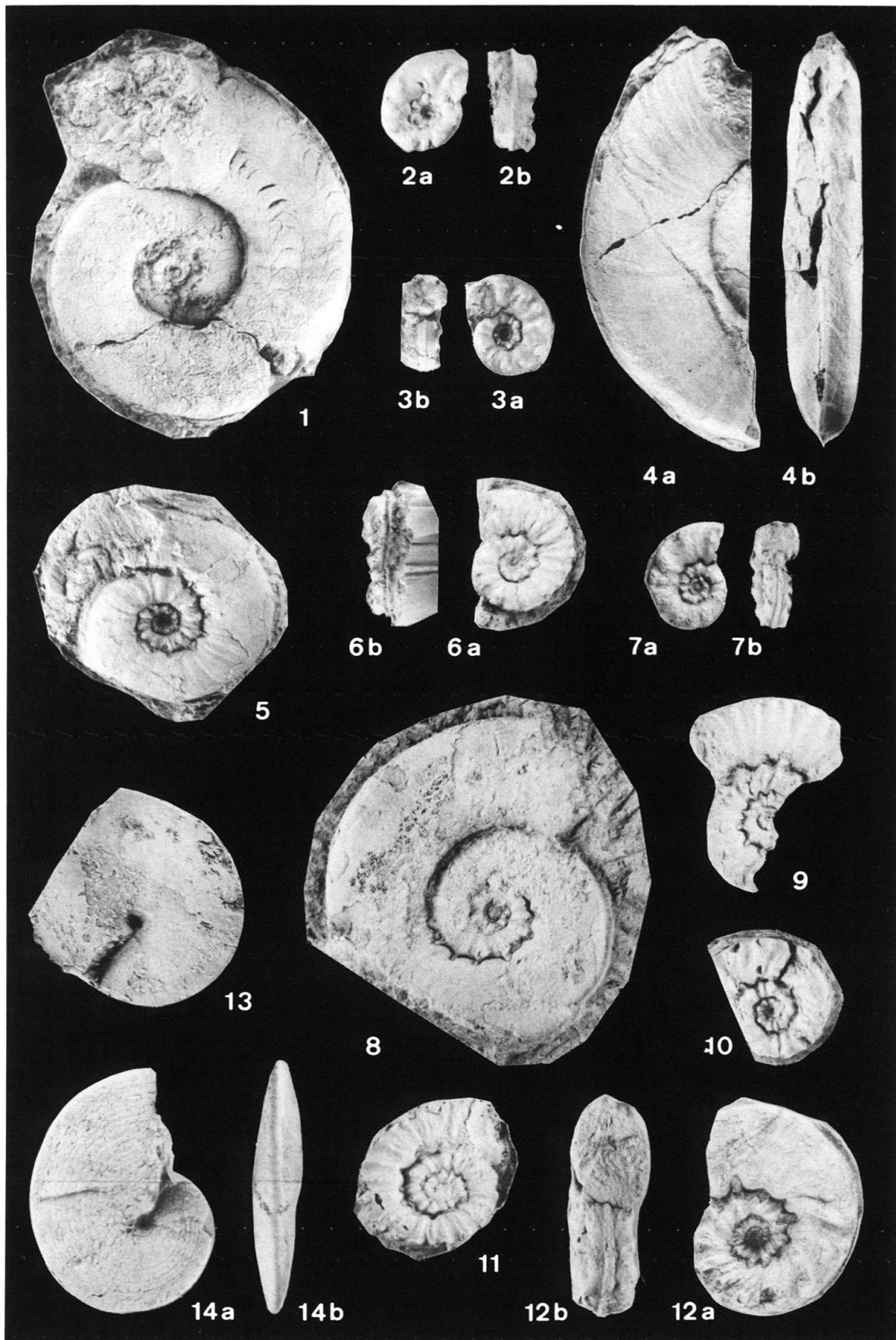

Plate 5

All figures natural size

- Fig. 1–4. *Caucasites nicholsi* n. sp. (p. 980). *Mulleri* Zone. Coyote Canyon, northern Humboldt Range.
1: holotype, USNM 438351, loc. HB 95.
2: plesiotype, USNM 438352, loc. HB 56.
3: plesiotype, USNM 438353, loc. HB 56.
4: plesiotype, USNM 438354, loc. HB 56.
- Fig. 5–10. *Groenlandites pridaense* n. sp. (p. 974). *Mulleri* Zone. Coyote Canyon, northern Humboldt Range.
5: plesiotype, USNM 438355, loc. HB 222.
6: plesiotype, USNM 438356, loc. HB 222.
7: paratype, USNM 438357, loc. HB 56.
8: paratype, USNM 438358, loc. HB 56.
9: holotype, USNM 438359, loc. HB 56.
10: plesiotype, USNM 438360, loc. HB 222.
- Fig. 11. *Groenlandites merriami* (p. 975). *Caurus* Zone. Loc. HB 225, Bloody Canyon, northern Humboldt Range. Holotype, USNM 438361.
- Fig. 12–13. *Grambergia* sp. indet. (p. 977). *Mulleri* Zone. Coyote Canyon, northern Humboldt Range.
12: USNM 438362, loc. HB 56.
13: USNM 438363, loc. HB 94.

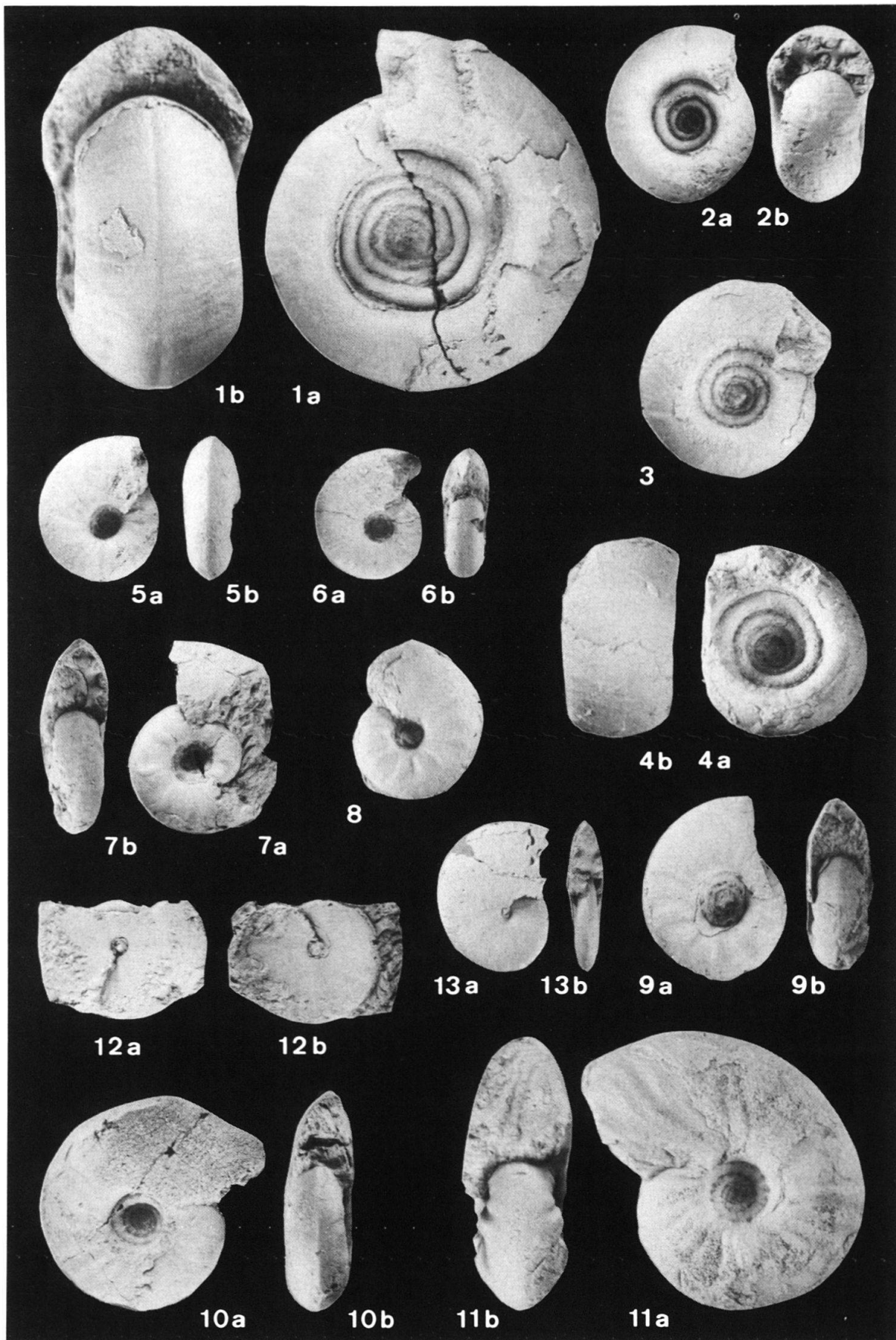

Plate 6

All figures natural size

- Fig. 1–3. *Gymnites billingsi* n. sp. (p. 982). *Mulleri* Zone. Loc. HB 56, Coyote Canyon, Northern Humboldt Range.
1: holotype, USNM 438364.
2: paratype, USNM 438365.
3: paratype, USNM 438366.
- Fig. 4–6. *Japonites welteri* n. sp. (p. 978). *Japonites welteri* beds. Northern Humboldt Range.
4: paratype, USNM 438367, loc. HB 235, Coyote Canyon.
5: plesiotype, USNM 438368, loc. HB 184, Star Creek Canyon.
6: holotype, USNM 438369, loc. HB 235, Coyote Canyon.
- Fig. 7–8. *Hemilecanites* cf. *H. paradiscus* KUMMEL (p. 961). *Japonites welteri* beds. Loc. HB 184, Star Creek Canyon, northern Humboldt Range.
7: plesiotype, USNM 438370.
8: plesiotype, USNM 438371.

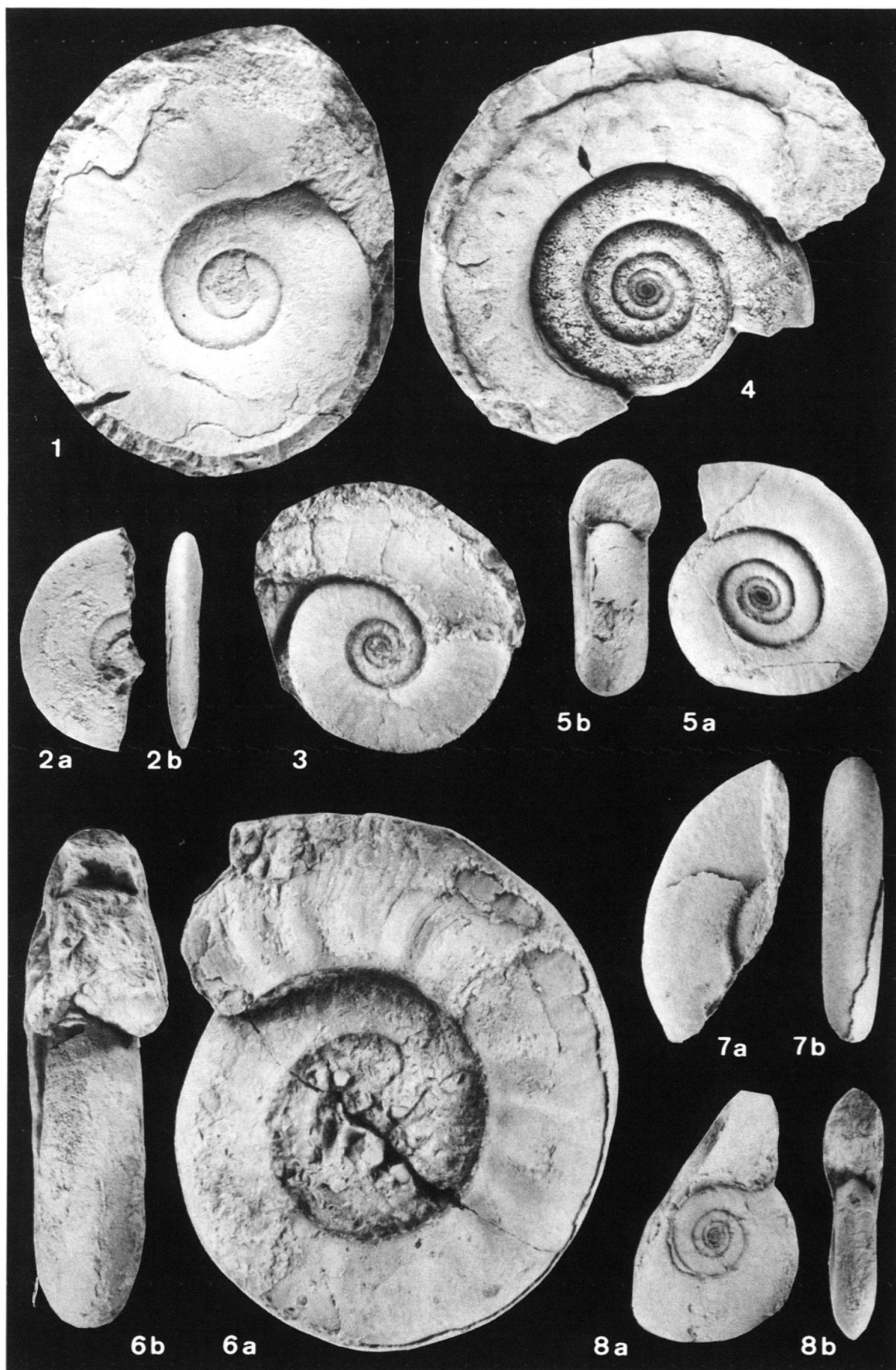
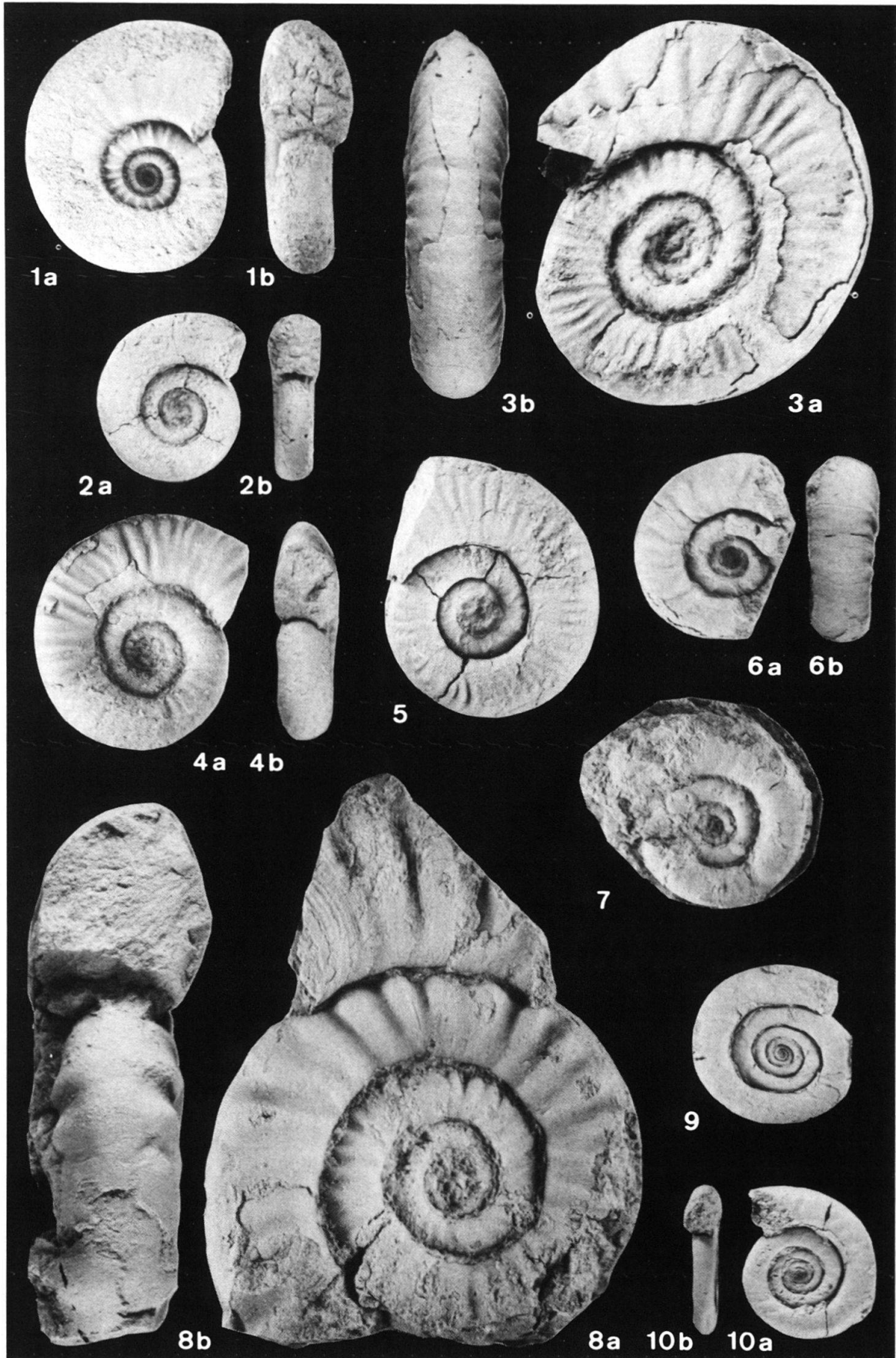
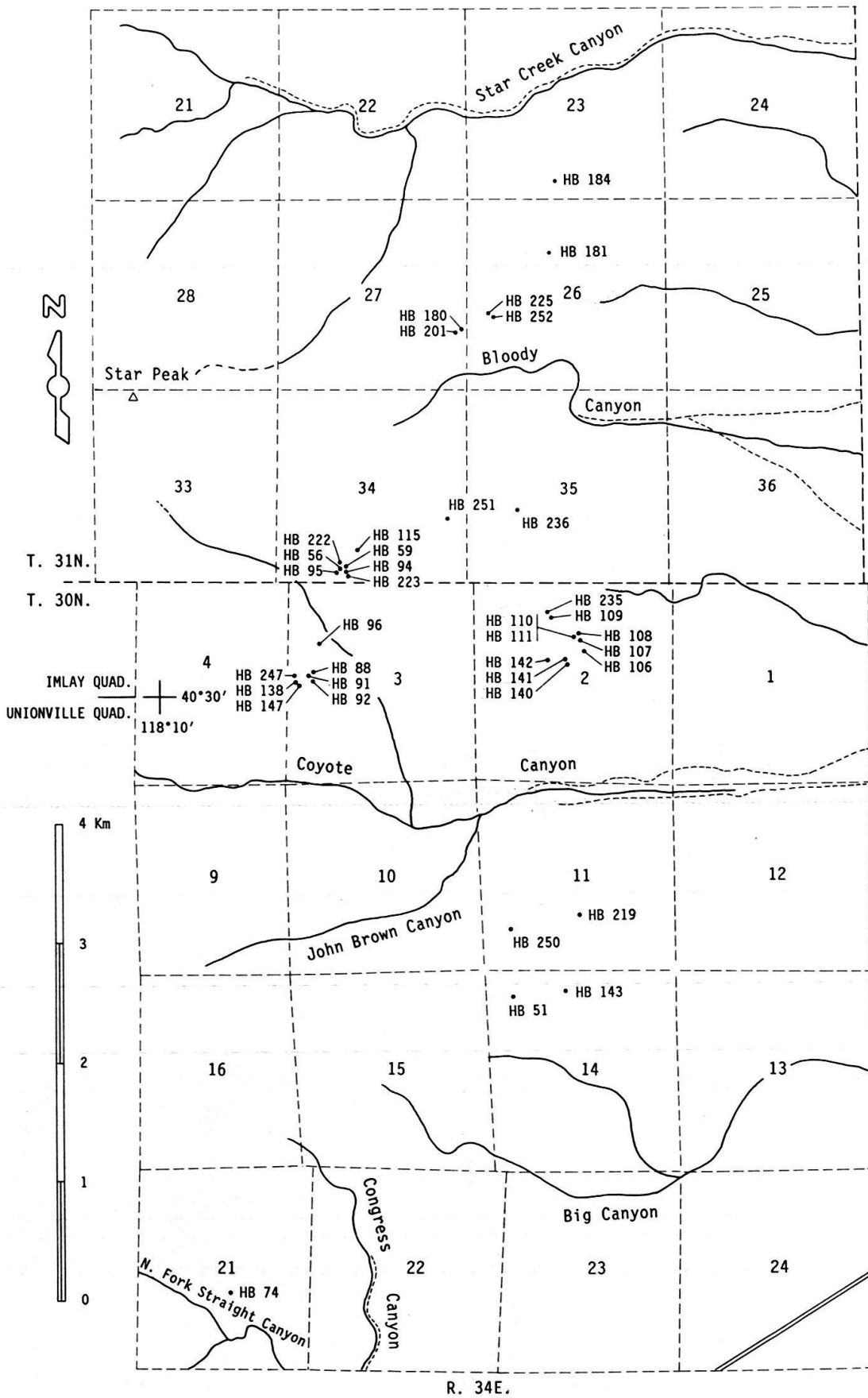

Plate 7

All figures natural size

- Fig. 1. *Ussurites detwilleri* n. sp. (p. 984). *Caurus* Zone. Loc. HB 225, Bloody Canyon, northern Humboldt Range. Holotype, USNM 438372.
- Fig. 2. *Ussurites* sp. indet. (p. 983). *Mulleri* Zone. Loc. HB 56, Coyote Canyon, northern Humboldt Range. USNM 438373.
- Fig. 3–5. *Paracrochordiceras* cf. *P. americanum* McLEARN (p. 972). *Mulleri* Zone. Coyote Canyon, northern Humboldt Range.
3: plesiotype, USNM 438374, loc. HB 95.
4: plesiotype, USNM 438375, loc. HB 56.
5: plesiotype, USNM 438376, loc. HB 95.
- Fig. 6–7. *Paracrochordiceras mclearni* n. sp. (p. 973). *Mulleri* Zone. Coyote Canyon, northern Humboldt Range.
6: holotype, USNM 438377, loc. HB 95.
7: plesiotype, USNM 438378, loc. HB 56.
- Fig. 8. *Danubites crassicostatus* n. sp. (p. 974). *Mulleri* Zone. Coyote Canyon, northern Humboldt Range.
8: holotype, USNM 438379, loc. HB 56.
- Fig. 9–10. *Leiophyllites* sp. indet. (p. 983). *Mulleri* Zone. Loc. HB 94, Coyote Canyon, northern Humboldt Range.
9: USNM 438380.
10: USNM 438381.





Appendix: Location map of localities referred to in the text. Superpositional relationships are given in chapter 3.